



Fiido M1-Pro User's Manual

SHENZHEN QLHX TECHNOLOGY CO., LTD.

No. 60, Dawei area 1, Longxin Community, Baolong street, Longgang District, Shenzhen

<http://www.fiido.com> email: support01@fiido.com



Made in China

Fiido Electric Bicycle Catalog

1. Important Note
2. Product components
3. Installation instructions
4. Folding instructions
5. Product parameters

1. Important Note

- a) This manual include important safety performance information and service information. Please make sure you have read the following warning content before the first time you use our product..
- b) If you borrow your electric bicycle to other people, please let the user read this manual, it could help to decrease the risk of accident.
- c) Please wear a suitable and safe helmet before riding, please wear the clothes with fluorescent and reflective stripes when you ride at night. Don't exceed speed limit, it is a main reason of traffic accident, we should abide by the traffic rule, we shouldn't exceed the speed limit.
- d) Don't touch the charging hole on the bike, or use metal touch it, otherwise, the accident will be caused by the transient short circuit of the current.
- e) Zero starting, braking frequent, driving against the wind, carrying people or anything, insufficient air pressure on the tires. All of these will use much electric energy, and then reduce the endurance mileage. If you want the best endurance mileage, please do something as follows:
 - 1. Please use assist mode.
 - 2. On the premise of safety, don't brake frequently or use zero starting.
 - 3. Don't overload.
 - 4. Before riding, please check the pressure of the tire, and supply enough pressure.
- f) Our Ebike should avoid prolonged exposure to the sun or rain, avoid storage in places with high temperature or corrosive gas, so as to avoid electroplating parts and paint surface by chemical corrosion and electrical parts damage, resulting in operational failure and accidents.
- g) When charging the electric bicycle, please make sure that there is no foreign matter in the charging port. Connect the charger to the bicycle first, then connect the AC power to prevent sparking.
- h) When the electric bicycle is not used for a long time, please turn off the main switch in time and charge it in time. Store the battery fully charged, don't store it in case of power loss, so as to avoid serious power loss of battery.
- i) Your current insurance business may not cover the situation you may encounter when riding a electric bike, please contact your insurance company or insurance broker for relevant consultation.
- j) According to the law in China, riding an electric bicycle or a three-wheeled Electric bike must reach the age of 16. If you use this product in other countries, please refer to the local laws and regulations.
- k) Bicycles are vehicles with certain risk factor, please be sure to abide by the traffic rules. At the same time, when emergency braking, brake the rear wheel first, then brake the front wheel, when cycling speed is too fast. There is a danger of tipping over if you brake the front wheel suddenly, please ride carefully.

2. Structure illustration

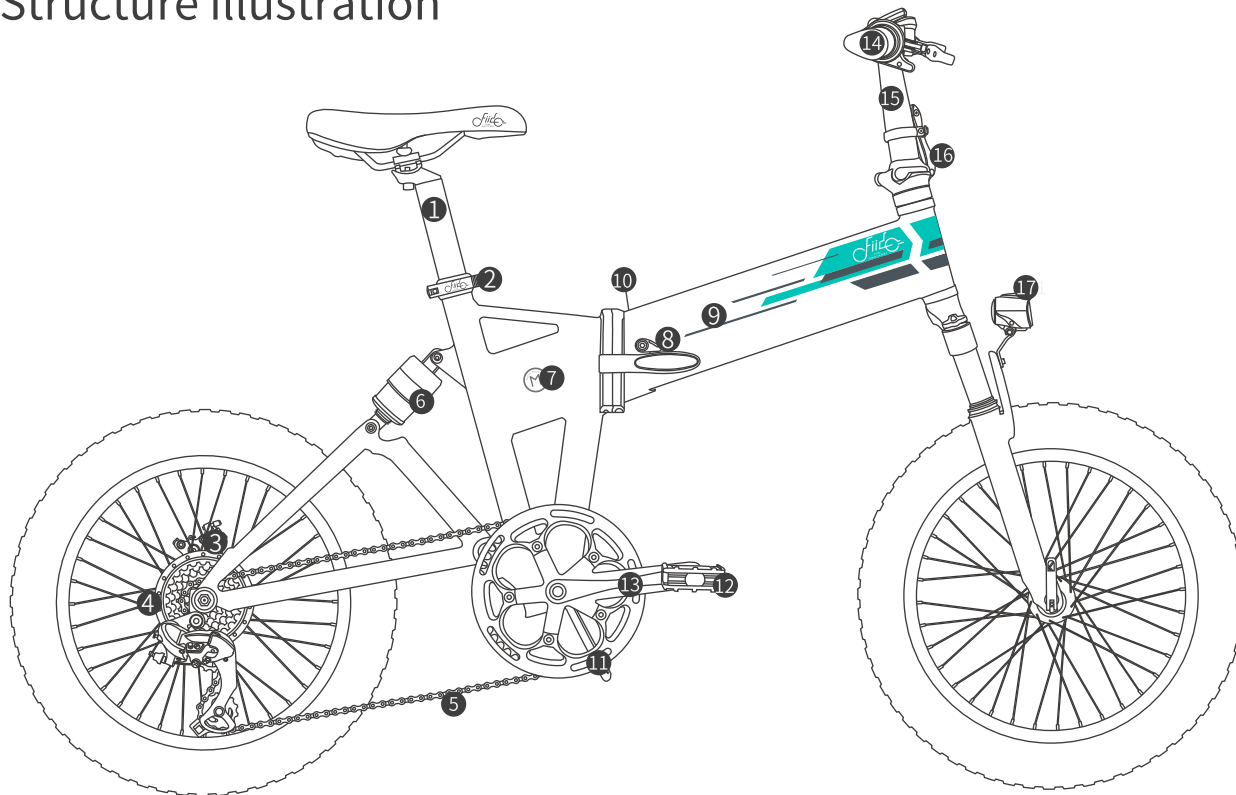

1.Seat tube
2.Quick lock
3.Brake disc
4.Motor

5.Chain
6.Shock absorber
7.Controller box
8.Folding system

9.Battery box
10.Charge port
11.Chain wheel
12.Pedal

13.Crank
14.Handle bar
15.Stem
16.Folding system

17.Headlight

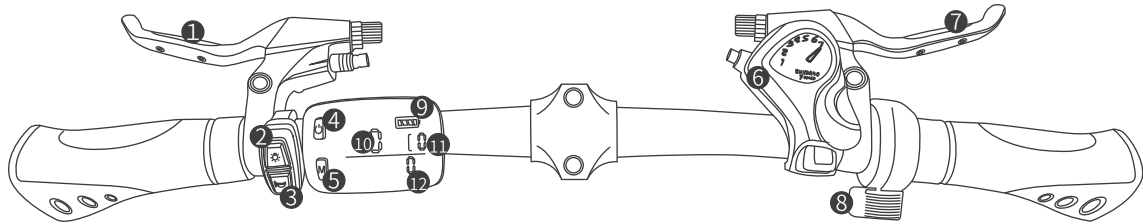

- | | | | |
|--------------------------|---|----------------------------|-------------------------|
| 1.Brake power off system | 4.Power on/off button(Long press on or off) | 7.Power off brake | 10.Speed |
| 2.Light/horn button | 5.Power adjustment | 8.Speed-up rotating handle | 11.Electric assist gear |
| 3.Horn | 6. Speed regulation | 9.Battery Level | 12.Use mileage |

(Note:After the bike is stationary, it does not run for 10 minutes to enter the sleep mode and automatically shut down)

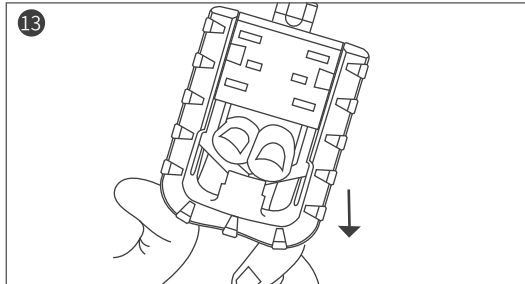

7.Hold and press with your fingers,folding the pedal

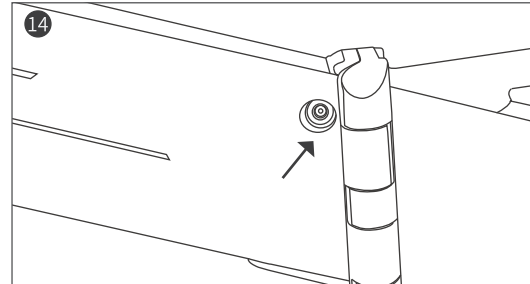

14.Battery charging port
(located below the main beam of the frame)

3. Installation instructions

1. Fold the riser to the upper end, lock the riser folding handle, adjust the riser safety hook to the tightening state, and adjust the position of the T handle.
2. Install front wheel; First install the front wheel on the front fork and lock the front wheel with screws.
3. Open the clip on the seat tube clamp and insert the seat tube into the position within the marking line on the seat tube. Adjust the seat to the comfortable height according to individual needs, and fasten the seat tube clip.

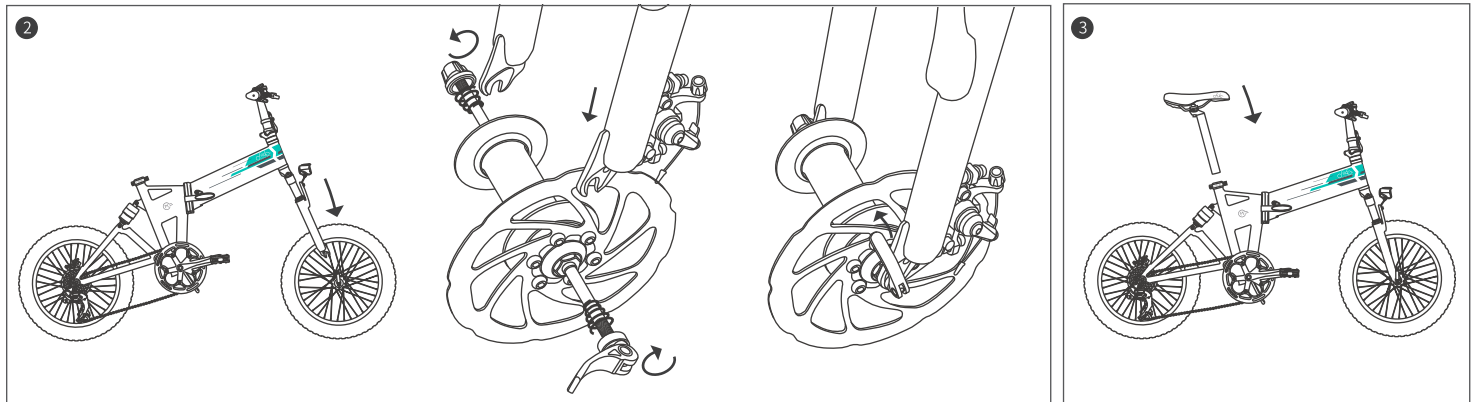
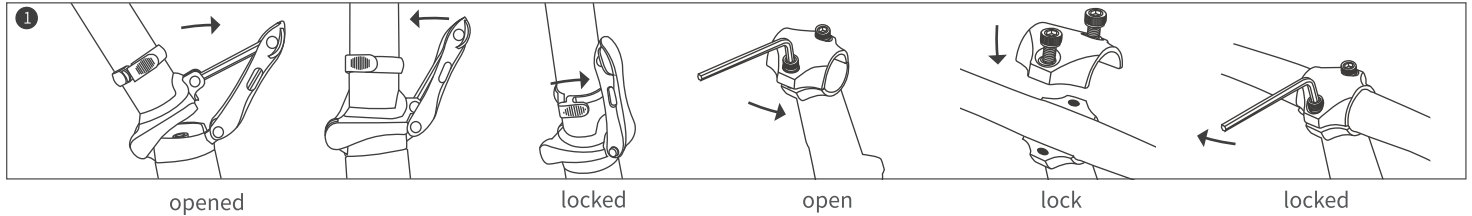

4. Please confirm the following items before riding: frame lock, standpipe lock and seat tube lock are locked.
5. Brake system is normal. Tires are adequately inflated. All these are important for a safe and comfortable riding.

4. Folding instructions

Step 1. Open the quick lock on the head end, to let the handle be perpendicular to the care frame.

Step 2. Open the quick lock on the Stem, lower the riser, as well as locking the quick lock.

Step 3. Open the Seat Tube quick lock, decentralized seats, as well as locking the quick the quick.

Note: Both the Rise and the Seat Tube are marked with a safe (MAX or MIN). For safety reasons, please use them in a safe range.

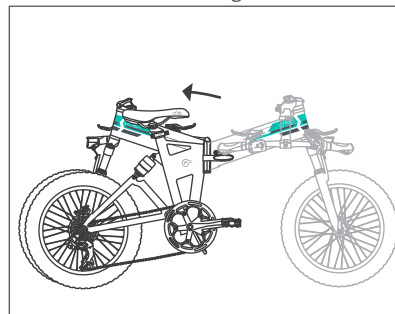
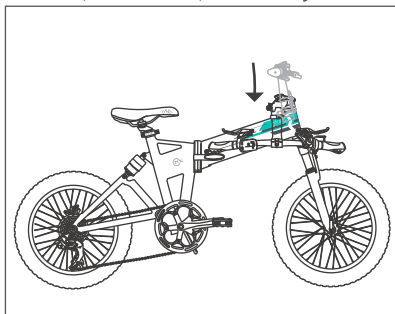
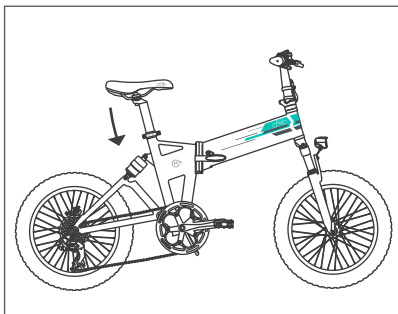

Step 4. Turn the buckle on the Standpipe clockwise and pull down the fold and fold down the front.

Step 5. Open the frame holder of the fuse buckle, pull the fold, and the frame.

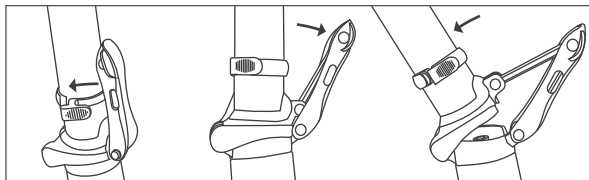

locked

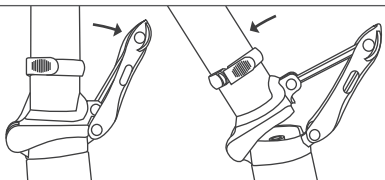

opened

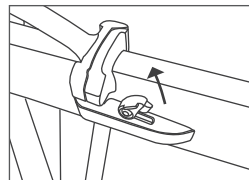

open

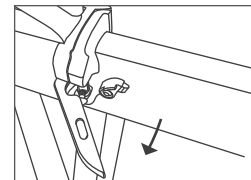

open

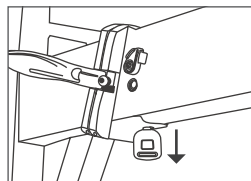
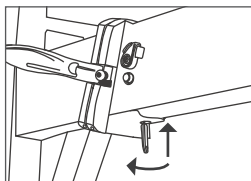

Remove Battery

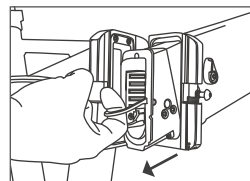

5. Product parameters

Name	Specification
Electric Bike System	Fiido System
Electric Motorcycle	Support
Power Assist System	Support
Power Assist System	3 Gears Assist
Max Load weight	120kg
Maximum Speed	50km/h
Maximum Range	Power assisted models up to 60KM~80KM
Battery	High quality lion battery 48V 12.8Ah
Battery adaptation	DC 54.6V2A
Recharge Time	7 hours
Drive Type	Rear Drive
Frame Material	Aluminum Alloy
Brake Type	Mechanical Disc Brakes
Chainset	Steel 52 Tooth
Gears	Shimano 7 speed
Chain	KMC Z7
Rear Brake	Mechanical Disc Brakes
Rear Hub/Rated Power	CZTB Motor/500W
Rims	Alloy
Wheel Size	20"
Tyre Size	20" × 4 inch
Tyres	Cheng Shin Tire
Net Weight	25kg
Folded Size	96cm*45cm*79cm
Size	172cm*26cm*106cm

* The above data allow for 5% manufacturing tolerances.

* After receiving the goods, there may be some differences between individual accessories and display drawings, which are different due to the different batches, and do not affect the use.